



UDHOME

Floor socket and floor box



OBO
BETTERMANN

O-line



Floor sockets and floor boxes: for perfect power and data connections.

The family of UDHOME complete units can locate power, data and multi-media connections exactly where they are required. Floor sockets and floor boxes of the UDHOME family are mounted directly on the raw floor and connected with flexibly installation pipes – it couldn't be simpler.



UDHOME2



UDHOME4

Elegant, discreet and robust

Thanks to their elegant, discreet design, UDHOME floor sockets and floor tanks integrate themselves seamlessly into the interior architecture. When the hinged cover is closed, only the high-quality surfaces of pure stainless steel or solid brass are visible. Thanks to their stable construction, the floor sockets and floor tanks are also resistant to the everyday loads in homes, offices and administrative areas.



Easy handling from ordering to mounting



High-quality materials and solid processing



Maximum flexibility in equipment



UDHOME9

A special customer: Old Master in a new light

Architect: Michele de Lucchi Museo della Pietà

The Museo della Pietà in Milan is home to the last, uncompleted masterpiece by Michelangelo: The Pietà Rondanini. The 89-year-old master worked on the sculpture, which depicts Jesus and Mary, just six days before his death in February 1564.

The compact UDHOME floor sockets and a special solution of OKA trunking from OBO Bettermann provide a discreet and flexible power supply around the famous sculpture.



Overview of the UDHOME series

Floor boxes

The UDHOME4 and UDHOME9 floor boxes are the ideal solution for a wide equipment range and dry-cleaned floor coverings. The floor boxes offer a lot of space for the installation of power, data and multimedia connections and are available in discreet stainless steel and in stylish brass.

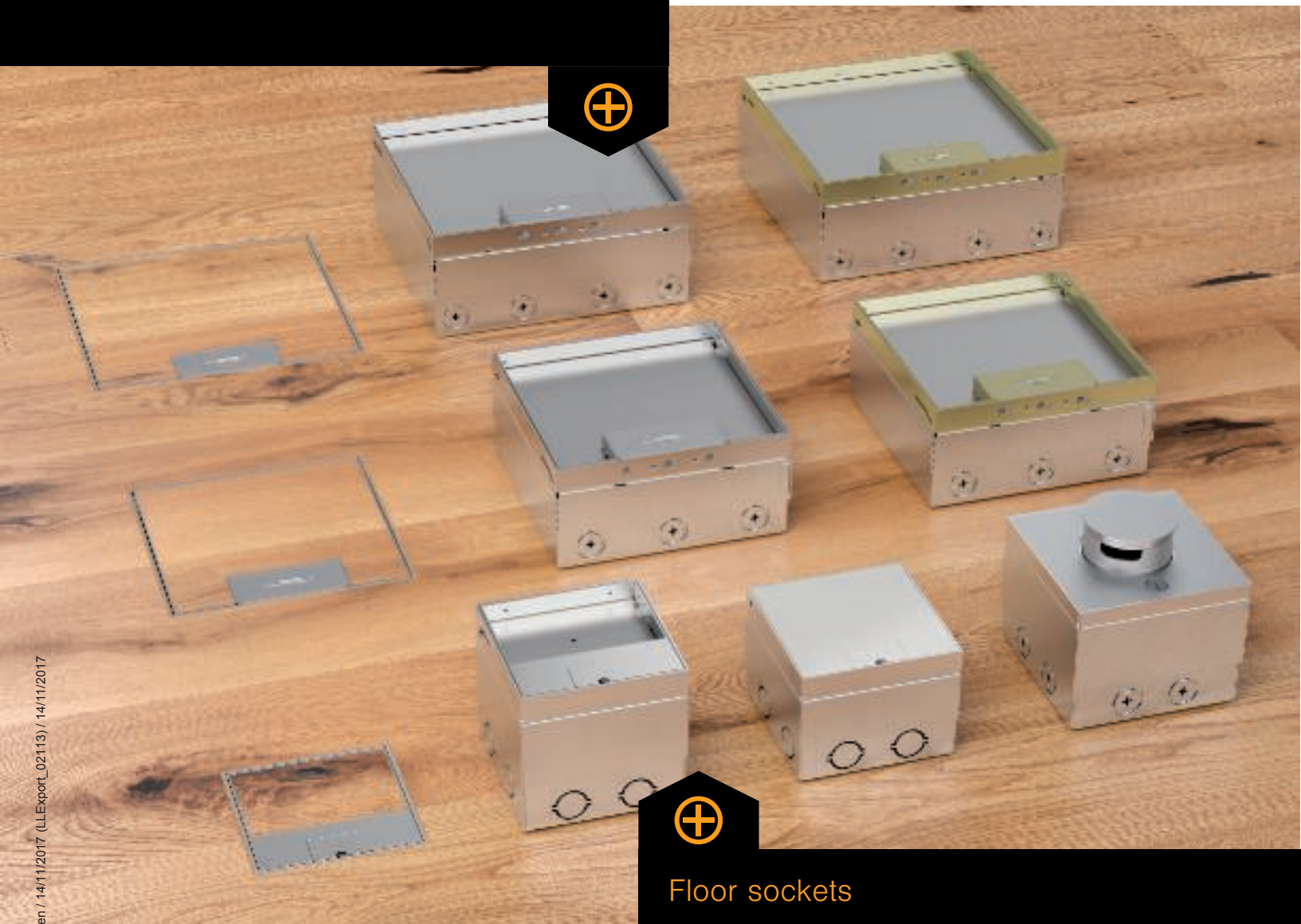

Floor sockets

The UDHOME2 floor sockets, with their dimensions of 125 x 125 mm, combine an elegant appearance and functionality. The product family offers solutions for dry and wet-cleaned floors. Stainless steel or aluminum are used as materials.

Floor structure

Thanks to their compact design, UDHOME floor sockets and floor boxes require considerably less space in the floor than other electrical installation systems do in floors.

Height-adjustment supports

With the easily accessible height adjustable supports, it is possible to adjust the covers of the floor sockets and floor boxes to the top edge of the floor coverings without any difficulty. The optional height extension means that adjustment is easy, even with higher floor structures.





Tested quality

In addition, OBO tests its ducts and underfloor boxes in its own BET Test Centre. Thus, special solutions can be tested for their load capacity within a very short time.

Simple infeed



The feeding in of cables is not complex. They are simply run in standard empty tubes in the screed up to the UDHOME.



Small but perfectly formed: The UDHOME2 floor socket

UDHOME2 are available in three versions: With stainless steel cover, with floor covering recess and with tube body. With its protection rating of IP65, the floor socket with tube body is suitable for use in wet-cleaned cavity and screed floors.



Height-adjustment

The cover is adjustable to the edge of the floor covering using four height-adjustment supports. A height extension with an additional adjustment range of 10–60 mm can be mounted for higher floor structures.



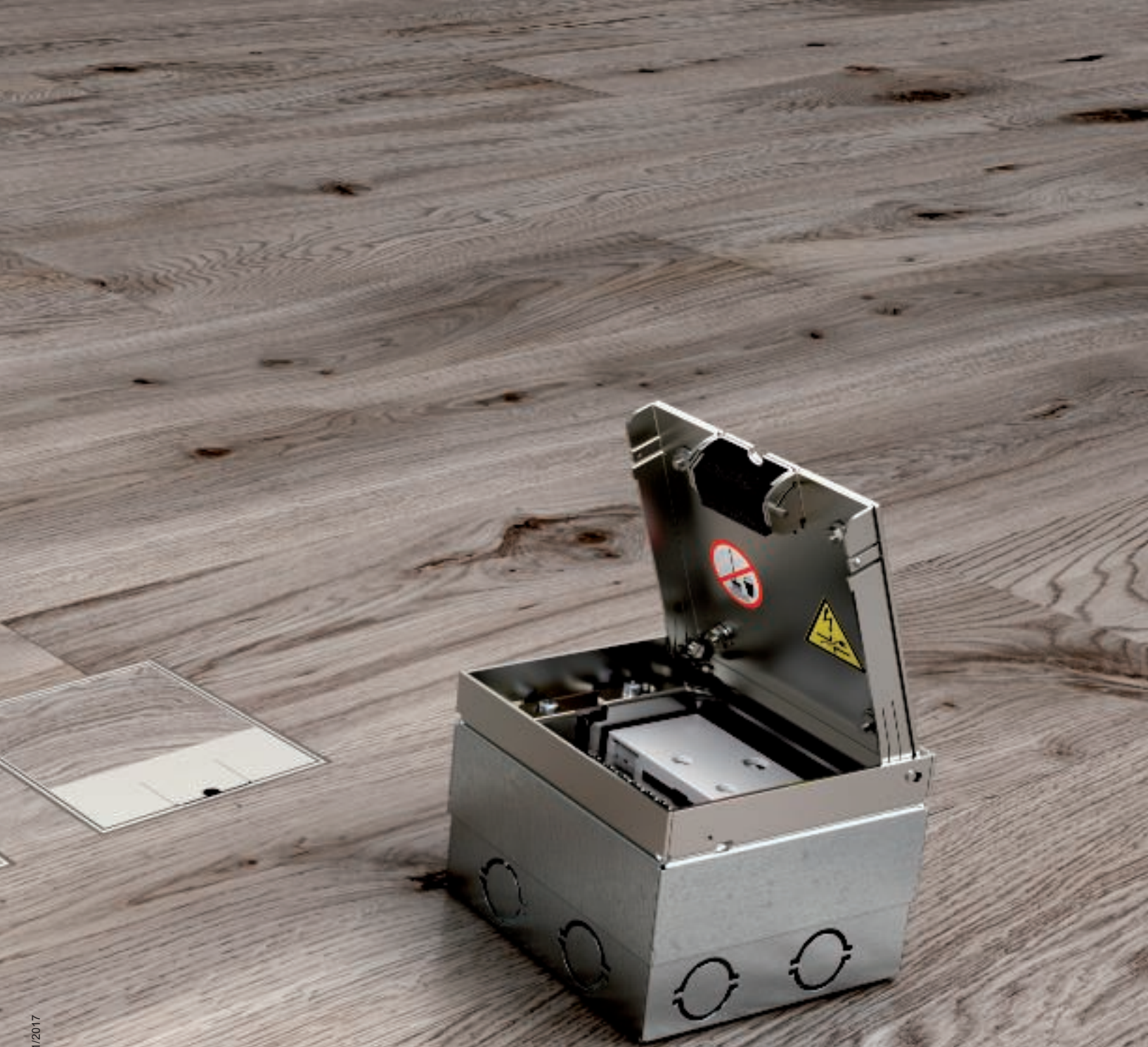

Device installation

The scope of delivery of the UDHOME2 contains a double protective contact socket. Up to two modular data sockets can be installed with the mounting supports.

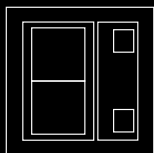

Connection

Eight pre-marked entry openings (M25) allow simple connection with flexible installation tubes.

For a wide range of equipment:
The UDHOME4 floor box



Design

The UDHOME4 can fit neatly into high quality interior architecture. All you can see is a slender metal edge and the cord outlet. The floor box is available in stainless steel or brass versions.

Device installation

The UDHOME4 can be equipped flexibly with power, data and multimedia technology using 4 support ring devices or 6 Modul 45 devices.

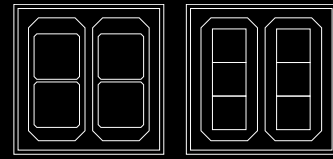

Dimensions

Body: 199 mm x 199 mm
Screed height: 95–110 mm
Floor height: 95–125 mm
Optional height extension

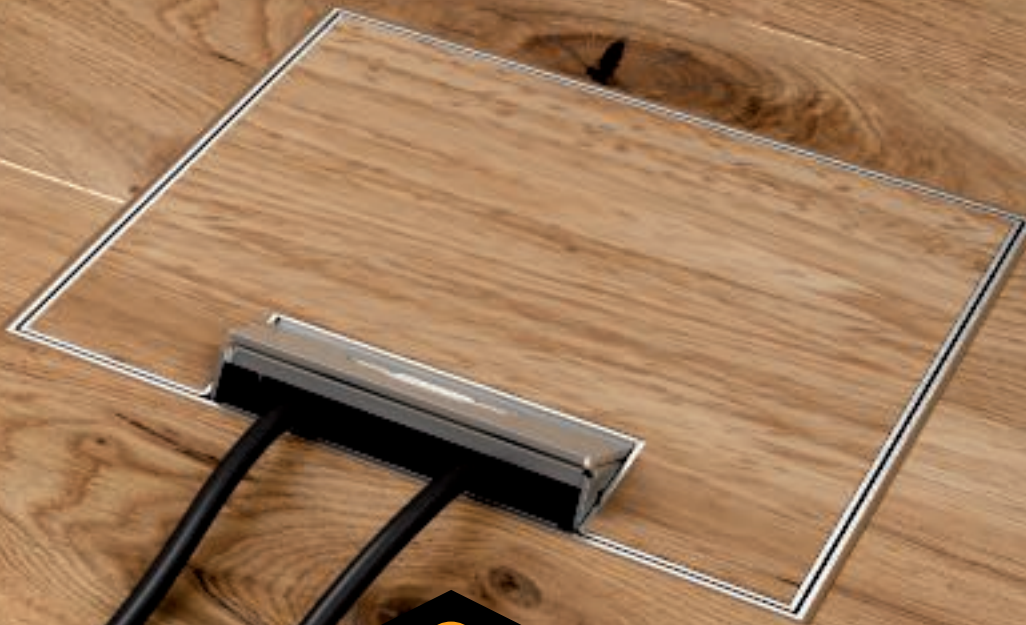

Height-adjustment

The flush-mount unit possesses a height-adjustment range of up to 30 mm and can thus be adjusted to the level of the finished floor.



A beautiful figure with powerful connections: The UDHOME9 floor box

Changeable



The UDHOME9 is available in stainless steel and brass versions.



Dimensions

Body: 243 mm x 243 mm
Screed height: 95–110 mm
Floor height: 95–125 mm
Optional height extension

Device installation

The UDHOME9 can be equipped flexibly with power, data and multimedia technology using 9 support ring devices or 12 Modul 45 devices.

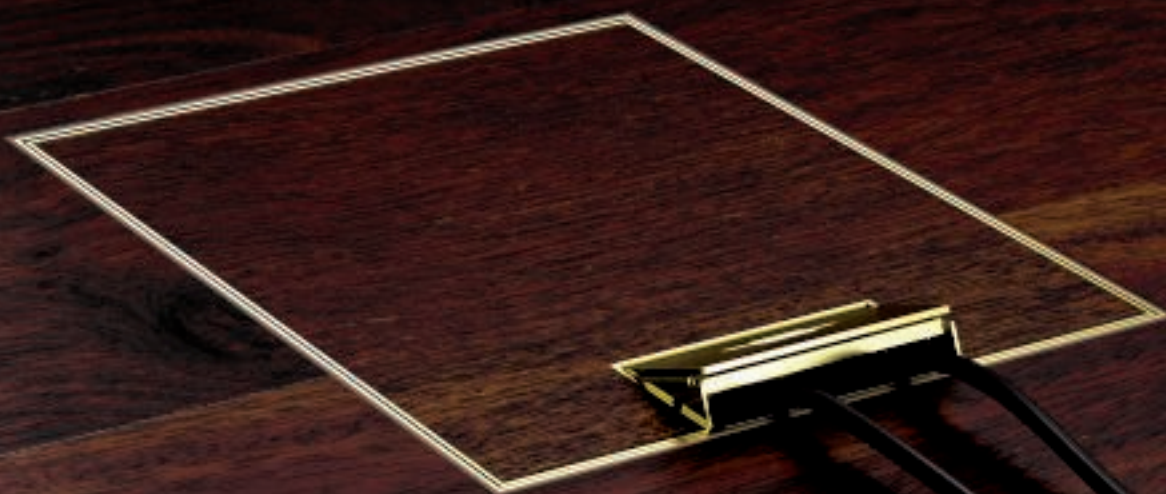
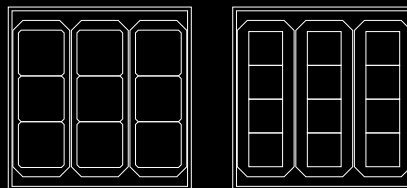

Installed

The UDHOME9 is the largest floor box of the UDHOME family. It combines restrained design with a wide range of use options.

Device installation

The UDHOME family can be equipped flexibly with power, data and multimedia technology. Our extremely comprehensive Modul 45 programme is available for this. However, you can also use standard devices from other manufacturers.

Maximum flexibility

For maximum flexibility, the floor sockets and floor boxes can, depending on requirements, be equipped with the comprehensive Modul 45 series from OBO Bettermann or with standard devices. Both sockets and data and multimedia technology of the Modul 45 series are simply snapped in, without tools, making work quicker and thus cheaper.

The system can be used for a wide range of applications, thanks to the standardised installation dimensions of 45 x 45 mm and the large range of variants (e.g. HDMI, USB and audio connections).





Floor socket

UDHOME2

2 Modul 45 devices
2 data technology modules

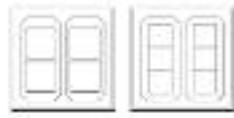

Floor box

UDHOME4

4 support ring devices
6 Modul 45 devices

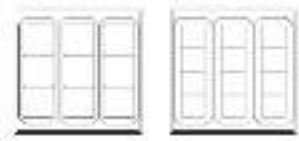

Floor box

UDHOME9

9 support ring devices
12 Modul 45 devices



Pre-equipped with
2 x Modul 45 sockets



Option 1: Installation of up to 6
devices when equipped with 2
universal supports
(type UT3 45 3)



Option 1: Installation of up to 12
devices when equipped with 3
universal supports
(type UT4 45 4)



Mounting support for data technol-
ogy for the optional installa-
tion of 2 additional data techno-
logy modules



Option 2: Installation of up to 4
devices when equipped with 2
support ring device supports



Option 2: Installation of up to 9
devices when equipped with 3
support ring device supports



UDHOME2 V floor socket, with floor covering recess in stainless steel lid, equipped

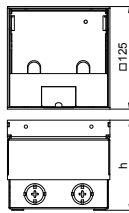

Type	Dimension h mm	Floor height mm	Floor covering thickness mm	Pack. pcs	Weight kg/100 pcs.	Item No.
UDHOME2 V SA	110	110 - 130	15	1	213,000	7427022

V2A Stainless steel, grade 305 /pc.

Square installation unit for use in dry-care cavity and screed floors. Installation housing with pre-marked insertion openings for pipes (M25). Cover adjustable to top edge of floor covering using four height-adjustment supports. The minimum installation depth is 110 mm, the height-adjustment range + 20 mm.

The scope of delivery contains a white single socket 16A, switched, and a blanking cover 1/2 module. Up to two modular data sockets (Keystones) can be installed with optional mounting supports.

Surfaces visible in the floor covering made of stainless steel.

UDHOME2 BV SA floor socket, with stainless steel lid, equipped

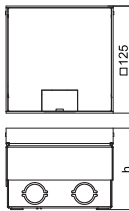

Type	Dimension h mm	Floor height mm	Pack. pcs	Weight kg/100 pcs.	Item No.
UDHOME2 BV SA	95	95 - 115	1	150,000	7427021

V2A Stainless steel, grade 305 /pc.

Square flush-mount unit for use in dry-cleaned cavity and screed floors. Fitted plug housing with pre-marked insertion openings for pipes (M25). Cover adjustable to top edge of floor covering using four height-adjustment supports. The minimum installation depth is 95 mm, the height-adjustment range + 20 mm.

The scope of delivery contains a white single socket 16A, switched, and a blanking cover 1/2 module. Up to two modular data sockets (keystones) can be installed with optional mounting supports.

Surfaces visible in the floor covering made of brushed stainless steel.

Height extension for UDHOME2 floor socket

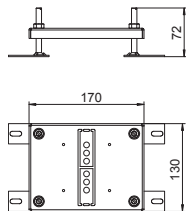

Type	Height adjustment range mm	Pack. pcs	Weight kg/100 pcs.	Item No.
HE60 UDHOME2	10 - 60	1	73,400	7368400

St Steel

FS Strip-galvanised

/pc.

Height-adjustable extension for UDHOME2 floor socket.

Mounting support, 2 x type C

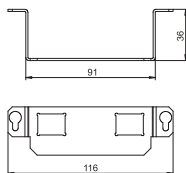

Type	Pack. pcs	Weight kg/100 pcs.	Item No.
MTGE2 2C	1	4,700	7407848

V2A Stainless steel, grade 304

/pc.

Mounting support to accept two data connection modules of the following types: Brand-Rex: shielded; EKU: E-Stone; Dätwyler: KS-T, MS-K and KU-T module; R&M: Snap-In and Keystone; Rutenbeck: UM and UMflex; SETEC: MKJ, UKJ and XKJ; Siemon TERA; Telegärtner: AMJ and UMJ.

Dimensions of a mounting opening in mm: 19.30 x 14.80.a

Suitable for GE2 / UDHome2 installation unit without floor covering recess.

UDHOME2 BV BS floor socket, with floor covering recess in stainless steel lid, equipped

Type	Dimension h mm	Pack. pcs	Weight kg/100 pcs.	Item No.
UDHOME2 V BS	85	1	210,000	7368392
V2A Stainless steel, grade 304 /pc.				
GUF Brushed and laminated				

Square installation unit for use in dry-care cavity and screed floors. With recess in the hinged lid for the floor covering. Installation housing with pre-marked insertion openings for pipes (M25). Cover adjustable to top edge of floor covering using four height adjustment supports. The minimum installation depth is 85 mm, the height adjustment range + 20 mm. The scope of delivery contains one BS socket with switch and a mounting support for up to two LJ6C data modules. Surfaces visible in the floor covering made of brushed stainless steel.

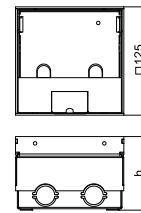

UDHOME2 BV BS floor socket, with stainless steel lid, equipped

Type	Dimension h mm	Pack. pcs	Weight kg/100 pcs.	Item No.
UDHOME2 BV BS	75	1	185,000	7368393
V2A Stainless steel, grade 304 /pc.				
GUF Brushed and laminated				

Square installation unit for use in dry-care cavity and screed floors. Installation housing with pre-marked insertion openings for pipes (M25). Cover adjustable to top edge of floor covering using four height adjustment supports. The minimum installation depth is 75 mm, the height adjustment range + 20 mm. The scope of delivery contains one BS socket with switch and a mounting support for up to two LJ6C data modules. Surfaces visible in the floor covering made of brushed stainless steel.

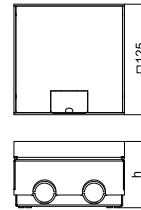

Height extension for UDHOME2 floor socket

Type	Height adjustment range mm	Pack. pcs	Weight kg/100 pcs.	Item No.
HE60 UDHOME2	10 - 60	1	73,400	7368400
St Steel /pc.				
FS Strip-galvanised				

Height-adjustable extension for UDHOME2 floor socket.

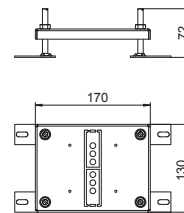

Mounting support, 2 x type C

Type	Pack. pcs	Weight kg/100 pcs.	Item No.
MTGE2 2C	1	4,700	7407848
V2A Stainless steel, grade 304 /pc.			

Mounting support to accept two data connection modules of the following types: Brand-Rex: shielded; EKU: E-Stone; Dätwyler: KS-T, MS-K and KU-T module; R&M: Snap-In and Keystone; Rutenbeck: UM and UMflex; SETEC: MKJ, UKJ and XKJ; Siemon TERA; Telegärtner: AMJ and UMJ.

Dimensions of a mounting opening in mm: 19.30 x 14.80.a

Suitable for GE2 / UDHome2 installation unit without floor covering recess.

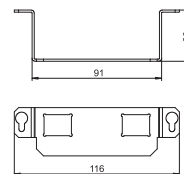

UDHOME4 floor box with GB2 mounting box, freely equippable, stainless steel

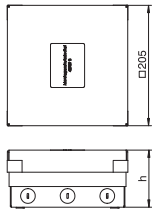

Type	Dimension h mm	Floor height mm	Floor covering thickness mm	Pack. pcs	Weight kg/100 pcs.	Item No.
UDHOME4 2V MT U	95	95 - 125	15	1	402,700	7427248
V2A Stainless steel, grade 304 /pc.						

Square floor box for use in dry-cleaned cavity and screed floors. Installation housing with pre-marked insertion openings for pipelines (M25). Cover adjustable to the top edge of the floor covering using four height-adjustment supports. The minimum installation depth is 95 mm, the height-adjustment range + 30 mm.

Surfaces visible in the floor covering made of stainless steel.

The scope of supply contains two module supports MT 3 45 2-1 for installation of up to 6 Modul 45 devices.

Height extension for UDHOME4 floor box

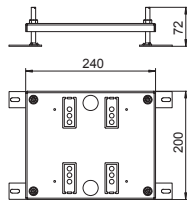

Type	Height adjustment range mm	Pack. pcs	Weight kg/100 pcs.	Item No.
HE60 UDHOME4	10 - 60	1	109,800	7427440
SI Steel /pc.				
FS Strip-galvanised				

Height-adjustable expansion for floor box UDHOME4.

Snap-in data connection module, Cat. 5e, unshielded

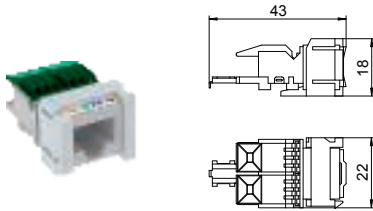

Type	Pack. pcs	Weight kg/100 pcs.	Item No.
ASM-C5 S	1	1,120	6117347

/pc.

Connection module Cat. 5e unshielded, with a RJ45 slot. Including a dust cover, a cable tie, a snap-in fastening frame and mounting instructions. Suitable for installation in support plates, type MTM 2C and MTM 3C, mounting plate type MPR2 2C, mounting support type MTGE2 2C, MTGE2 15 2C and MTGE2 F 2C.

Snap-in data connection module, Cat. 5e, shielded

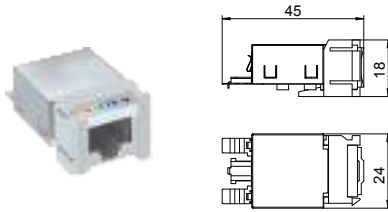

Type	Pack. pcs	Weight kg/100 pcs.	Item No.
ASM-C5 GS	1	1,920	6117348

/pc.

Connection module Cat. 5e shielded, with a RJ45 slot. Including an EMC screen hood, a dust cover, a cable tie, a snap-in fastening frame and mounting instructions. Suitable for installation in support plates, type MTM 2C and MTM 3C, mounting plate type MPR2 2C, mounting support type MTGE2 2C, MTGE2 15 2C and MTGE2 F 2C.

Snap-in data connection module, Cat. 6, unshielded

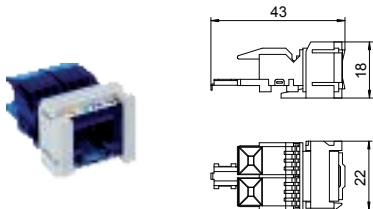

Type	Pack. pcs	Weight kg/100 pcs.	Item No.
ASM-C6 S	1	1,060	6117349

/pc.

Connection module Cat. 6 unshielded, with a RJ45 slot. Including a dust cover, a cable tie, a snap-in fastening frame and mounting instructions. Suitable for installation in support plates, type MTM 2C and MTM 3C, mounting plate type MPR2 2C, mounting support type MTGE2 2C, MTGE2 15 2C and MTGE2 F 2C.

Snap-in data connection module, Cat. 6, shielded

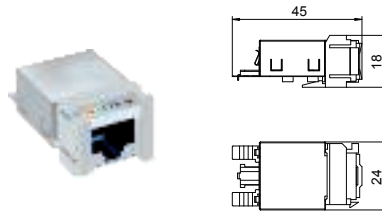

Type	Pack. pcs	Weight kg/100 pcs.	Item No.
ASM-C6 GS	1	1,850	6117345

/pc.

Connection module Cat. 6 shielded, with a RJ45 slot. Including an EMC screen hood, a dust cover, a cable tie, a snap-in fastening frame and mounting instructions. Suitable for installation in support plates, type MTM 2C and MTM 3C, mounting plate type MPR2 2C, mounting support type MTGE2 2C, MTGE2 15 2C and MTGE2 F 2C.

RJ45 data connection module, Cat. 6A, unshielded

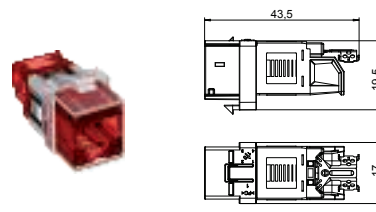

Type	Pack. pcs	Weight kg/100 pcs.	Item No.
ASM-C6A	1	1,050	6117348

/pc.

Connection module Cat. 6A (ISO) unshielded, with a RJ45 slot. Including a dust cover, a cable tie, a Keystone fastening frame and mounting instructions. Suitable for installation in the data technology supports of type DTG-2C and DTS-2C, support plate of type MTM 2C and MTM 3C, mounting plate of type MPR2 2C, mounting supports of type MTGE2 2C, MTGE2 15 2C and MTGE2 F 2C.

RJ45 data connection module, Cat. 6A, shielded

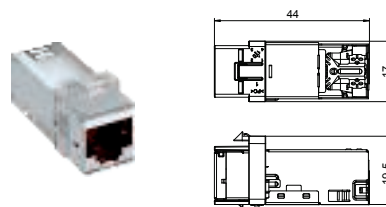

Type	Pack. pcs	Weight kg/100 pcs.	Item No.
ASM-C6A G	1	1,630	6117346

/pc.

Connection module Cat. 6A (ISO) shielded, with a RJ45 slot. Including an EMC screen hood, a dust cover, a cable tie, a Keystone fastening frame and mounting instructions. Suitable for installation in the data technology supports of type DTG-2C and DTS-2C, support plate of type MTM 2C and MTM 3C, mounting plate of type MPR2 2C, mounting supports of type MTGE2 2C, MTGE2 15 2C and MTGE2 F 2C.

Data technology support, 1 module, slanting outlet, type RM

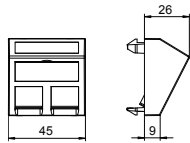

Type	Colour	Pack.	Weight	Item No.
		pcs	kg/100 pcs.	
DTS-2RM RW1	Pure white	1	2,900	6119298
PC Polycarbonate		/pc.		

Data technology support with slanting outlet and locking slider to accept two data technology connection modules with RJ45 socket. The locking fastening is suitable for horizontal and vertical installation in the system environment. Type RM has a special module seat and is designed for indirect fastening of the data connection modules in the mounting opening.

The type RM data technology support is suitable for accepting the following data connection modules: Types ASM-C5, ASM-C5 G, ASM-C6 and ASM-C6 G; R&M: Cat.5 and Cat.6 modules without support plate.

Blanking cover 1/2 module width

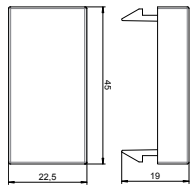

Type	Colour	Pack.	Weight	Item No.
		pcs	kg/100 pcs.	
ADP-B RW0.5	Pure white	10	0,400	6117414
		/pc.		

Blanking lid for closing off empty spaces for a half device (1/2 module).

Blanking cover, whole module width

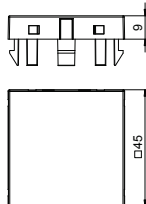

Type	Colour	Pack.	Weight	Item No.
		pcs	kg/100 pcs.	
ADP-B RW1	Pure white	10	0,800	6117406
		/pc.		

Blanking lid for closing off empty spaces for a device (one module).

USB charging device



Type	Colour	Pack.	Weight	Item No.
		pcs	kg/100 pcs.	
MTG-2UC1.2 RW1	Pure white	1	5,500	6105291
PC Polycarbonate		/pc.		

USB charging device with two USB type A sockets, for charging 1–2 mobile devices, maximum charging current 1 x 1,200 mA or 2 x 600 mA.

Socket 0°, South Africa/India, 16 A, single

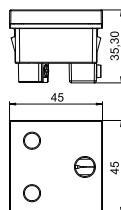

Type	Colour	Pack.	Weight	Item No.
		pcs	kg/100 pcs.	
STD-SA0 RW1	Pure white	1	5,000	6120730
PC Polycarbonate		/pc.		

Socket, single 0°, South Africa/India, conforming to BS 546, with increased touch protection, with screw terminals, 2-pin, 16 A, 250 V~.

Socket 0°, South Africa/India, 16 A, encoded version, single

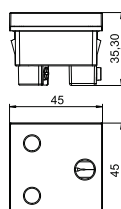

Type	Colour	Pack.	Weight	Item No.
		pcs	kg/100 pcs.	
STD-SA0K SRO1	Signal red	1	5,000	6120732
PC Polycarbonate		/pc.		

Socket, single 0°, South Africa/India, encoded version, conforming to BS 546, with increased touch protection, with screw terminals, 2-pin, 16 A, 250 V~.

Socket 0° with switch, South Africa/India, 16 A, single

Type	Colour	Pack. pcs	Weight kg/100 pcs.	Item No.
STD-SA0G RW1.5	Pure white	1	6,700	6120734

PC Polycarbonate /pc.

Socket, single 0°, with switch, South Africa/India, conforming to BS 546, with increased touch protection, with screw terminals, 2-pin, 16 A, 250 V~.

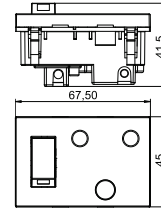

Socket 0°, with switch, South Africa/India, 16 A, encoded version, single

Type	Colour	Pack. pcs	Weight kg/100 pcs.	Item No.
STD-SA0GK SRO1.5	Signal red	1	6,700	6120736

PC Polycarbonate /pc.

Socket, single 0°, with switch, South Africa/India, encoded version, conforming to BS 546, with increased touch protection, with screw terminals, 2-pin, 16 A, 250 V~.

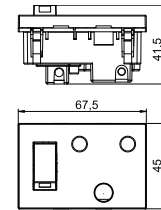

Socket 0°, protective contact, single

Type	Colour	Pack. pcs	Weight kg/100 pcs.	Item No.
STD-DO RW1	Pure white	1	4,200	6120008

PC Polycarbonate /pc.

Protective contact socket single 0°, with increased touch protection, with screwless terminals, 2-pin, 16 A, 250 V~, with connection terminals to IEC 60884-1.

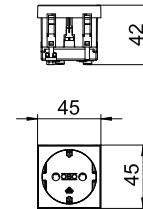

Socket single 45°, with switch

Type	Colour	Pack. pcs	Weight kg/100 pcs.	Item No.
ONESTO 16A SSO	White	1	5,600	6560000

Socket, single 45°, with switch, South Africa/India, conforming to BS 546, with increased touch protection, with screw terminals, 2-pin, 16 A, 250 V~.

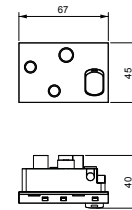

Socket single 45°, encoded with switch

Type	Colour	Pack. pcs	Weight kg/100 pcs.	Item No.
ONESTO 16A SSO D	Red	1	5,600	6560002

Socket, single 45°, with switch, South Africa/India, encoded version, conforming to BS 546, with increased touch protection, with screw terminals, 2-pin, 16 A, 250 V~.

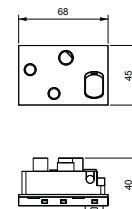

Surge protection device, 1/2 module, acoustic signalling



Type	Signalling on device	Version	Pack. pcs	Weight kg/100 pcs.	Item No.
ÜSS 45-A-RW	Audible	Acoustic function display	1	2,800	6117465

/pc.

Surge protection / network fine protection, type 3, according to EN 61643-11 for installation in Rapid 45 ducts, device installation ducts and underfloor systems.

- Version-A with acoustic function display (switchable signal tone)
- Quick and easy mounting
- Low construction width of 22.5 mm

Application: The surge protection device secures downstream and nearby sockets.

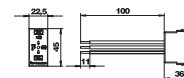

Surge protection module with support

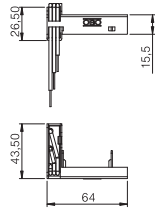

Type	Signalling on device	Pack. pcs	Weight kg/100 pcs.	Item No.
ÜSM-A-4T	Audible	1	2,226	6107801

/pc.

2-pin surge protection module, 16 A/250 V~, with acoustic default display, no network switch-off, for connection to a multiple socket of type Modul 45connect using the supplied support. For installation in universal supports UT3/45 and UT4/45. The surge protection module meets EN 61643-11, type 3, Class III, requirements Class D.



SOUTH AFRICA

O-line (Pty) Ltd - Head Office

Reg. No. 1982/000082/07
14/16 Prop Street
Selby Ex t. 11
Johannesburg 2001
P.O Box 6457
Johannesburg 2000
South Africa
Tel: (+27) 011-378-3700
Fax: (+27) 011-493-0048
email: o-line@o-line.com

O-line Kwazulu-Natal

Unit 1, Chelsea Road
Industrial Park
17 Chelsea Road
New Germany 3610
P.O. Box 2534
New Germany 3620
South Africa
Tel: (+27) 031-705-6355
Fax: (+27) 031-705-6358
email: o-linekzn@o-line.com

O-line Port Elizabeth

26 Paterson Road
North End
Port Elizabeth 6001
P.O. Box 1352
Port Elizabeth 6000
South Africa
Tel: (+27) 041-486-3674
Fax: (+27) 041-484-5463
email: o-linepe@o-line.com

O-line Pretoria

219 Battery Street
Silverton
Pretoria
P.O. Box 2039 Silverton
0127
South Africa
Tel: (+27) 012-803-1803
Fax: (+27) 012-803-1733
email: o-linepta@o-line.com

O-line Bloemfontein

Cnr Frikkie Van Kraayenburg
& Naude Du Toit Street
New East-End
Bloemfontein 9300
P.O.Box 29809
Danhof 9310
Tel:(+27) 051-432-0707
Fax: (+27) 051-432-0708
email: o-linebfn@o-line.com

O-line Cape Town

Unit 2, 6 Thor Circle
Viking Place
Thornton 7460
P.O. Box 506
Eppindust 7475
South Africa
Tel: (+27) 021-531-9071
Fax: (+27) 021-531-8092
email: o-linecpt@o-line.com

INTERNATIONAL

O-line Mocambique Limitada

Reg. No. 2009/1001240/68
Rua Bebeluane
Parcela 510
Djuba, Matola-Rio
Maputo
Tel: (00) 258-217 30243
Fax: (00) 258-217 30244
e-mail: o-linemz@o-line.com

OBO Ghana

Reg. No CS036372016
Plot No.53, Flower Pot,
Spintex Road Accra Ghana
Tel: (00) 233-5015 22488
Fax: (00) 233-2441 94426
e-mail: obo.ghana@obo-bettermann.com

www.o-line.com



O-line